

# How to reset PC from Advanced startup:

To reset computer from the Advanced startup settings, use these steps:

(Important: This process will delete everything on your device. It's recommended to make a full backup of your computer before proceeding.)

1. Start device.
2. Immediately after the Power-On Self-Test (POST), press the Power button again to shutdown.
3. Repeat the steps No. 1 and 2 twice, and in the third restart the operating system should enter in the Windows Recovery Environment (Windows RE).
4. Click the Advanced options button.
5. Click on "**Troubleshoot**".

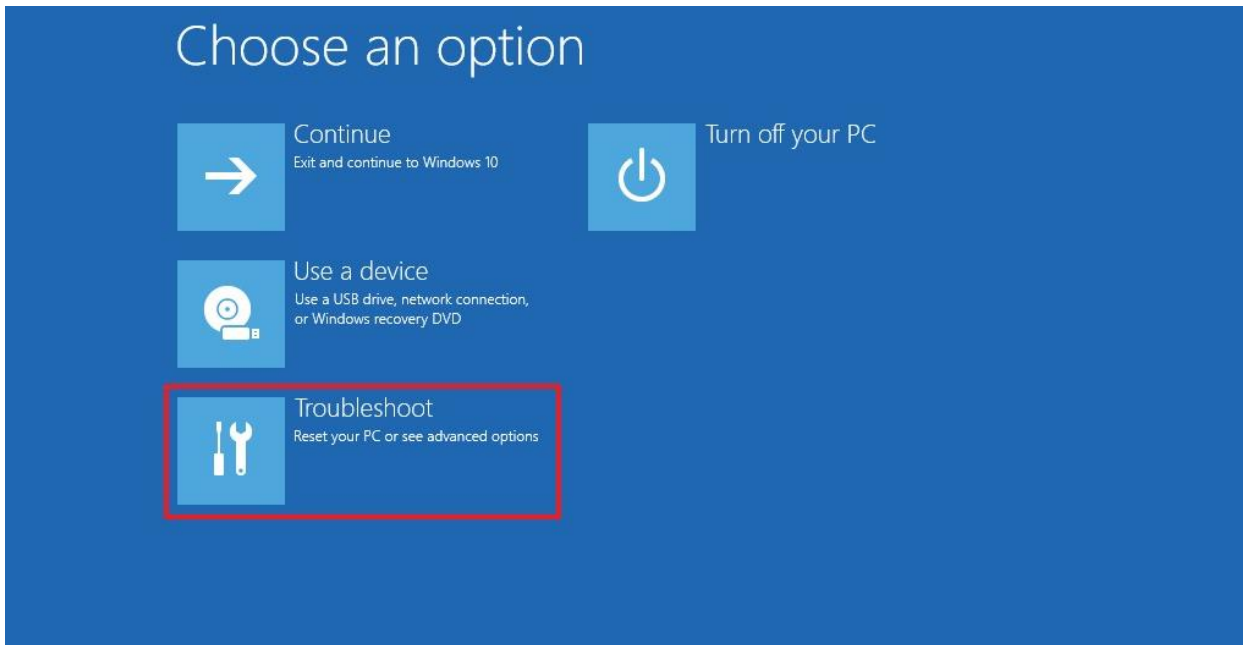

6. Click on "**Reset this PC**" option.

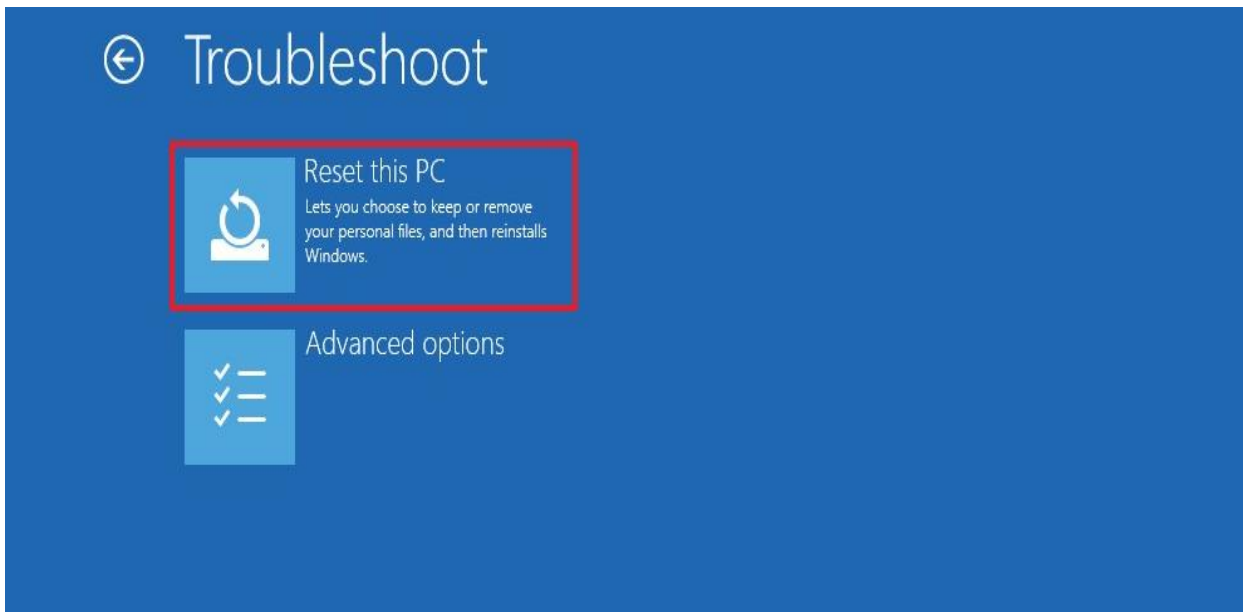

7. Select the “**Remove everything**” option

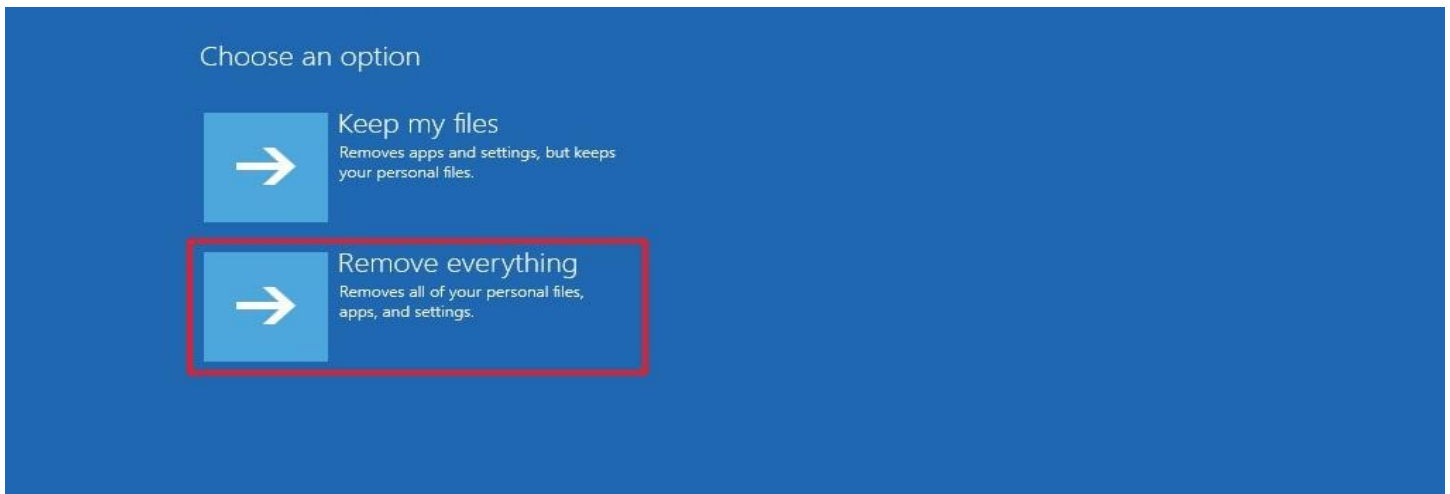

8. Click the “**Local reinstall**” option.

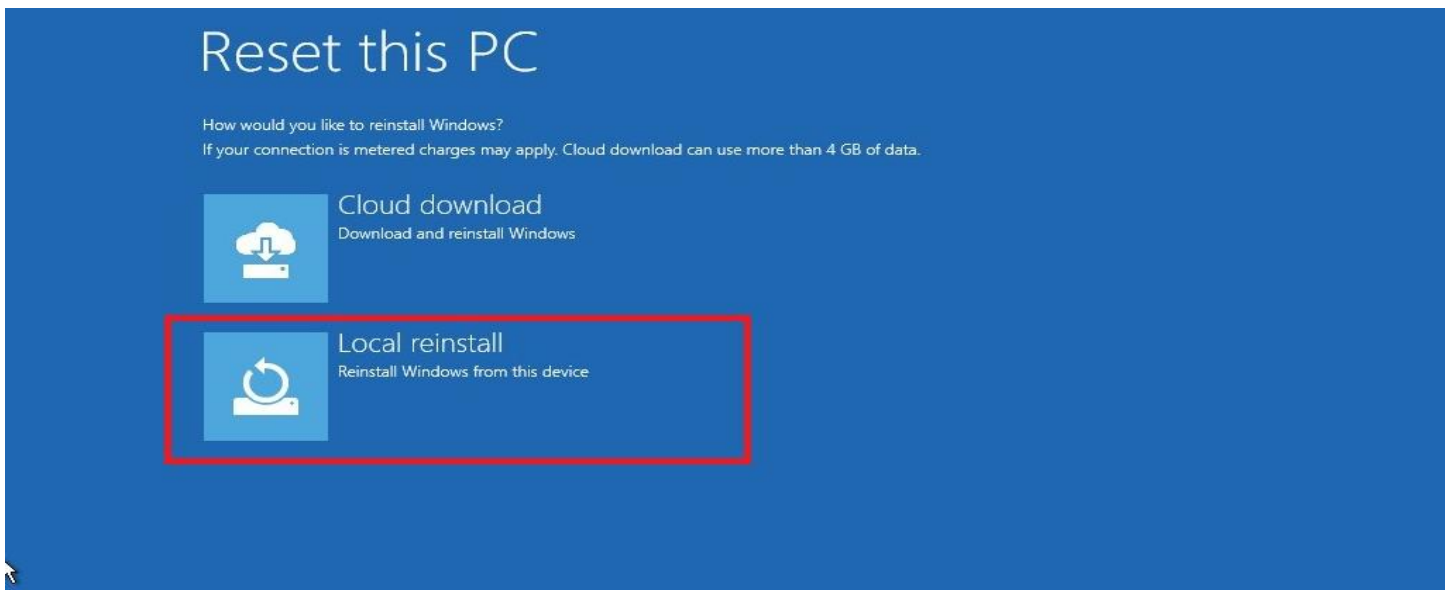

9. Select the “**Just remove my files**” option.

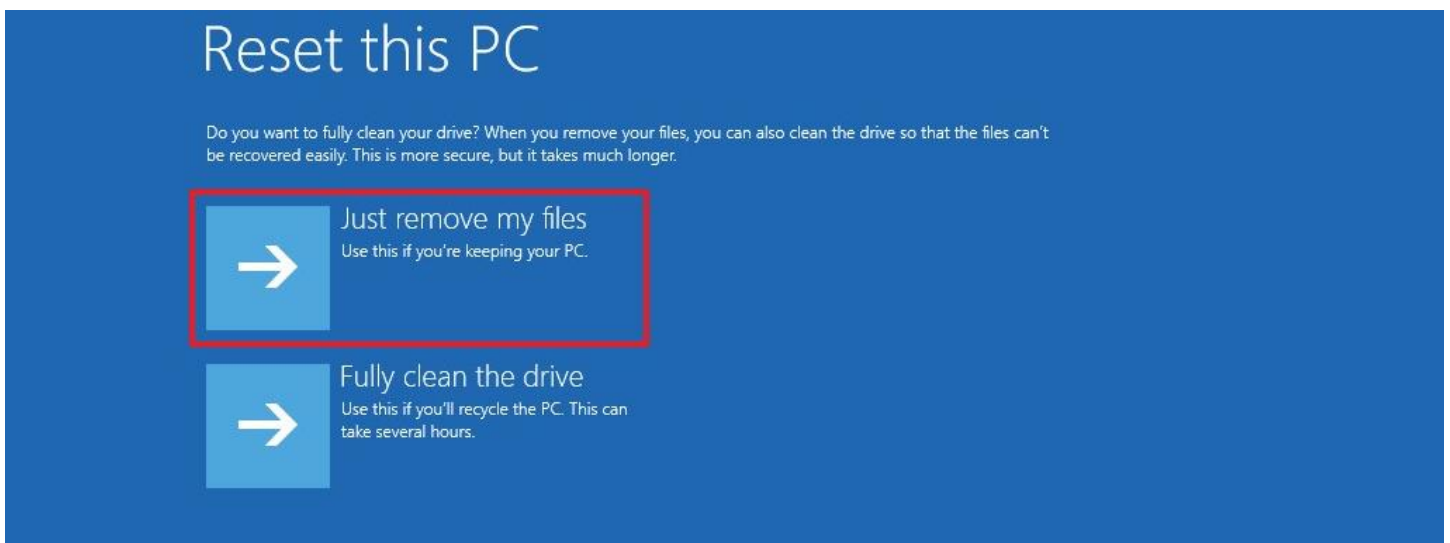

10. Click the “**Reset**” button.

**\*\*It’s important during this you do not unplug or turn off the computer. After about 15-25 minutes the computer will automatically restart. The computer will then re-image back to the original setting when it was first delivered to you.**